

LTD ED TROUBLEMAKER TELECASTER (0176020XXX)

PARTS LAYOUT

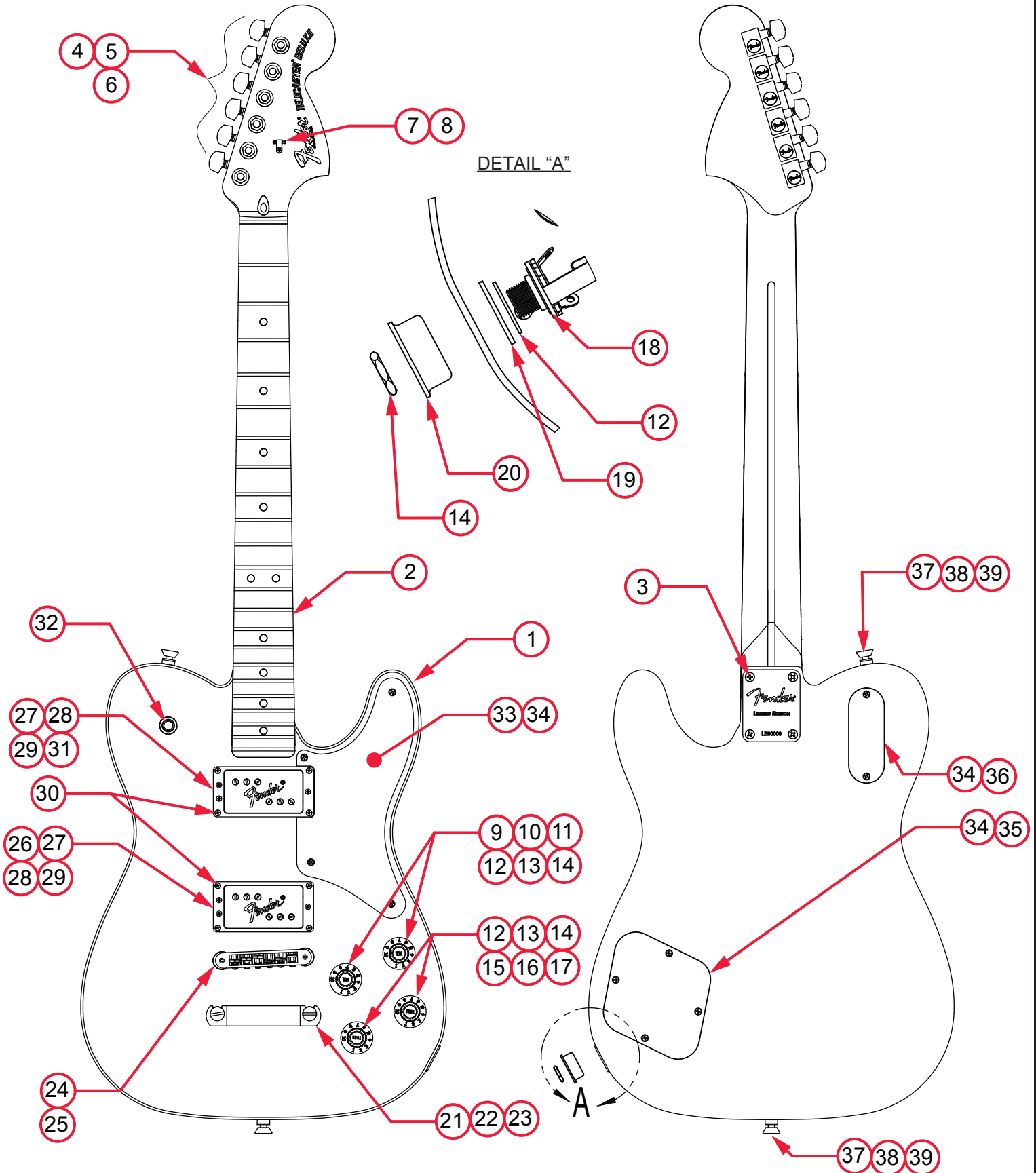

LTD ED TROUBLEMAKER TELECASTER (0176020XXX)

PARTS LIST

| REF# | DESCRIPTION | PART NUMBER |
|------|--|-------------|
| 1 | BODY LTD ED TROUBLEMAKER TELE ITB | 7712102574 |
| 1 | BODY LTD ED TROUBLEMAKER TELE IBM | 7712102583 |
| 2 | NECK ASSY TROUBLEMAKER TELE MAHOGANY/RW | 7712046000 |
| 3 | SCREW WOOD #8 X 2 OHP STL NI | 0058060049 |
| 4 | KEYS GUITAR DUAL PIN MTG SET W/HDWR | 0990820100 |
| 5 | WASHERS KEY | 0053106049 |
| 6 | BUSHINGS KEY | 0058820049 |
| 7 | STRING GUIDE TREE AM STD W/HDWR | 0994911000 |
| 8 | SCREW SMAB 3 X 3/8 RHP STL NI | 0011357049 |
| 9 | KNOB JAZZMASTER VOLUME AGED WHITE | 7712261030 |
| 10 | CONTROL 500K A-TAPER .25 X .625 S-SHAFT W/HDWR | 0990835000 |
| 11 | PCB ASSY TREB BLEED AM PRO STRAT/TELE | 7711092000 |
| 12 | WASHERS LOCKING INTL 3/8 X .687 X .035 NI | 0016436049 |
| 13 | WASHERS FLAT 3/8 X .614 NI | 0031153049 |
| 14 | NUT HEX 3/8-32 X 3/32 TK NI | 0016352049 |
| 15 | CAPACITOR MPF RDL .022µF 250V 10% | 0024832049 |
| 16 | CONTROL 250K SOLID SHAFT 3/8" | 0053803000 |
| 17 | KNOB JAZZMASTER TONE AGED WHITE | 7712262030 |
| 18 | JACK PHONE OPEN CIRCT 11 | 0021956049 |
| 19 | RETAINER JACK NI PLT TELE | 0010355069 |
| 20 | FERRULE JACK STD TELE CHROME | 0021452000 |
| 21 | BUSHING ANCHOR STOPBAR API | 0096192000 |
| 22 | STUD STOPBAR CHROME API | 0096189000 |
| 23 | TAILPIECE STOPBAR API CHROME | 0096194000 |
| 24 | BRIDGE ASSY JAZZMASTER API | 0096187000 |
| 25 | POST W/BUSHING TOM API CHR | 0096188000 |
| 26 | PICKUP ASSY AM PRO TELE DLX AGED WHT BRIDGE | 7710448000 |
| 27 | RING HUMB P/U FLAT AGED WHITE | 0068310030 |
| 28 | SPRINGS HUMB MTG 3/4" | 0050167049 |
| 29 | SCREW MACH #3-48 X 7/8 RHP NI | 0058404000 |
| 30 | SCREW SMAB 3x3/4 FHP BLX | 0053161049 |
| 31 | PICKUP ASSY AM PRO TELE DLX BLK NECK | 7710449000 |
| 32 | 3-WAY TOGGLE SWITCH CHROME/CREAM TIP W/HDWR | 7705067000 |
| 33 | PICKGUARD TELE TROUBLEMAKER CREAM | 7712141000 |
| 34 | SCREW SMAB 4 X 1/2 OHP NI | 0015578049 |
| 35 | COVER BACK PLATE TORONADO CREAM | 7713487000 |

*= NOT PICTURED IN DIAGRAM



LTD ED TROUBLEMAKER TELECASTER (0176020XXX)

WIRING ASSEMBLY

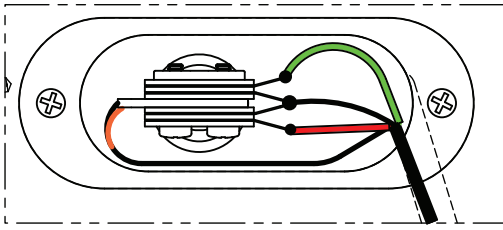



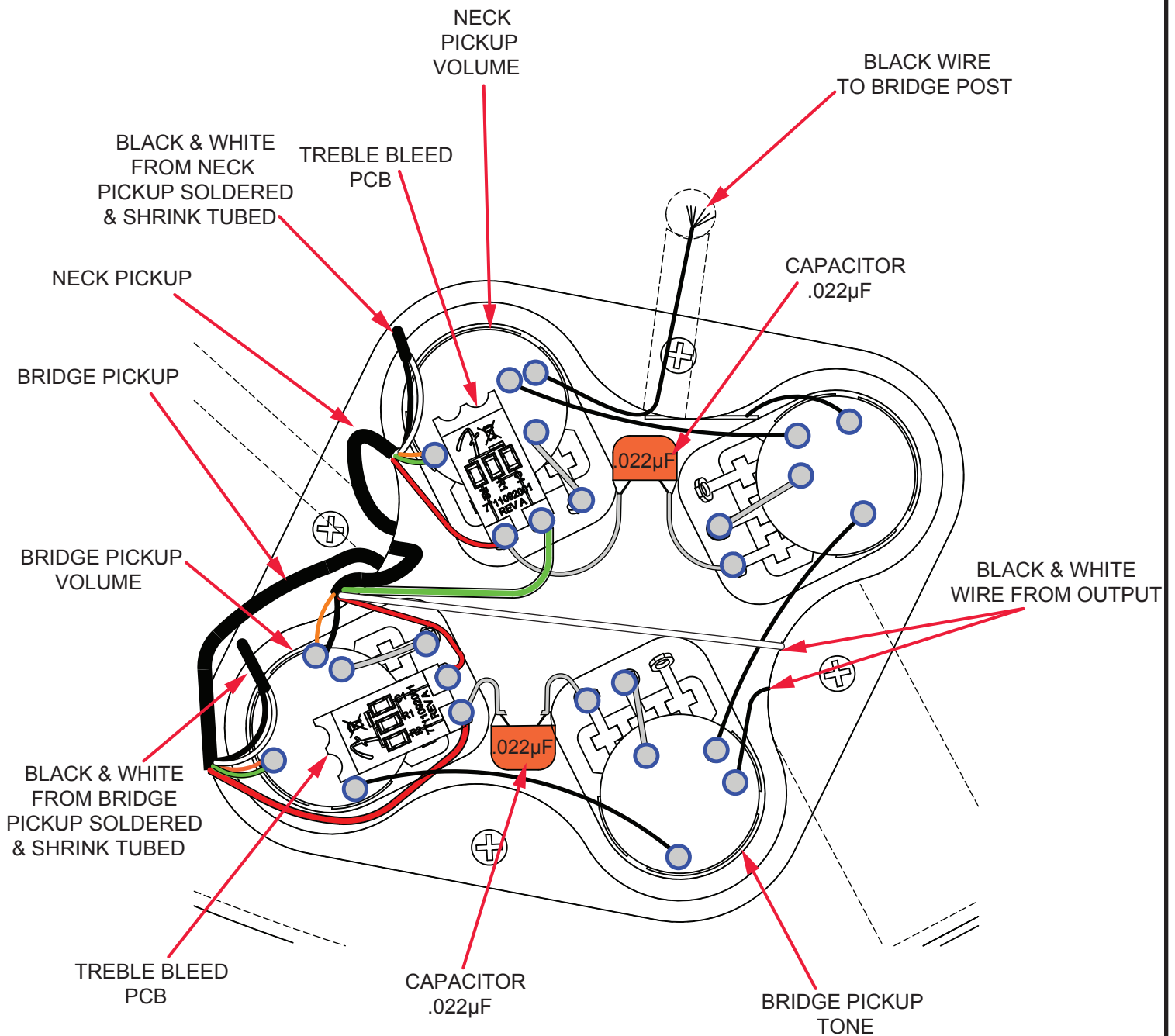



TOGGLE SWITCH

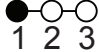

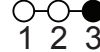
LTD ED TROUBLEMAKER TELECASTER (0176020XXX)

SWITCH AND CONTROL FUNCTION

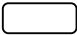
| SWITCH FUNCTION | | | POSITION |
|--|--|---|---|
|  |  |  | |
| V1 + T1 | V1/V2 + T1/T2 | V2 + T2 | CONTROLS |
|  |  |  | NECK PICKUP |
| | | | BRIDGE PICKUP |
|  PICKUP IS ON | | |  PICKUP IS OFF |
| | | | |

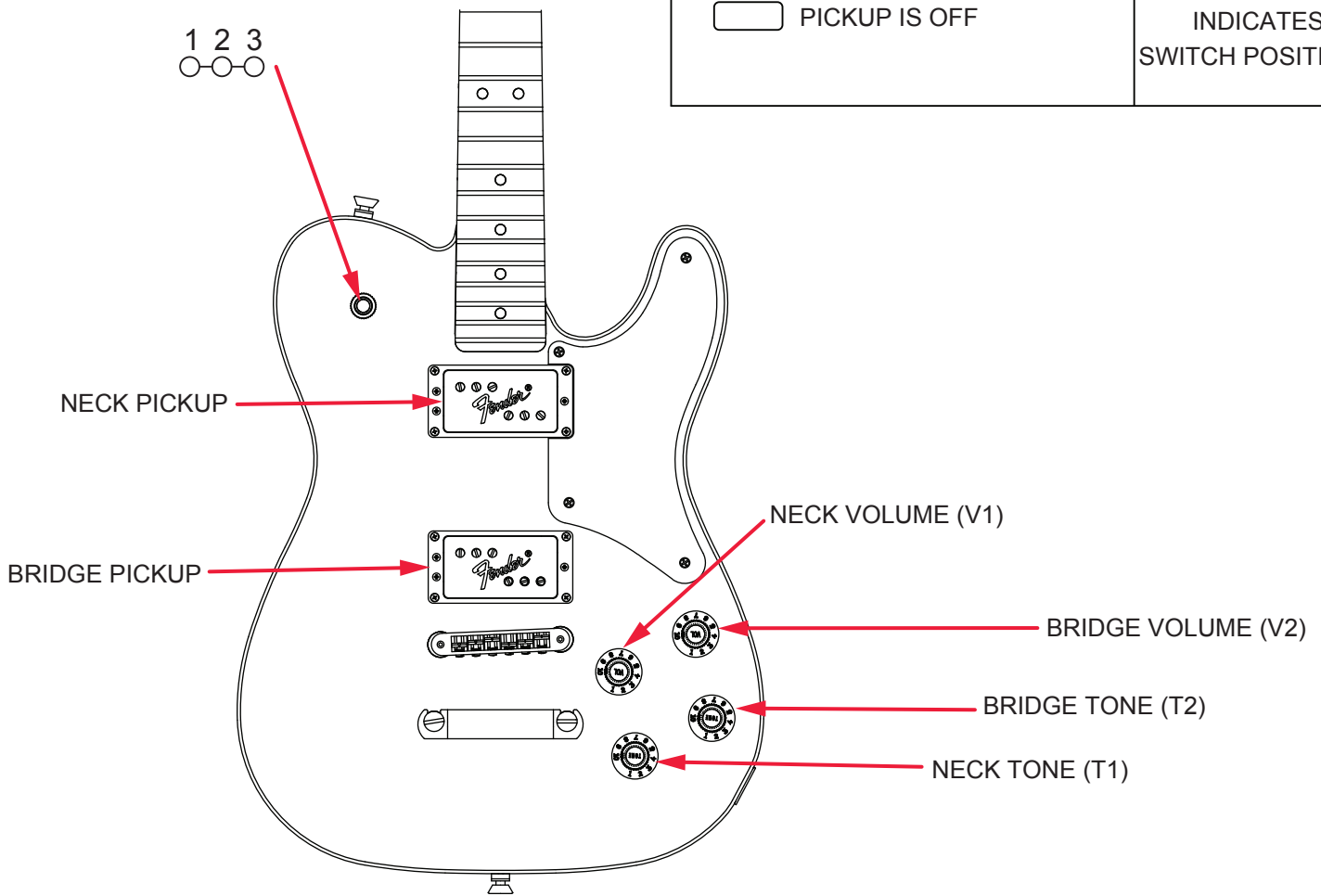

LTD ED TROUBLEMAKER TELECASTER (0176020XXX)

ADDITIONAL SPECIFICATION DETAIL

FRET SIZE: NARROW JUMBO
(FRET DIMENSIONS ARE BEFORE INSTALLATION)

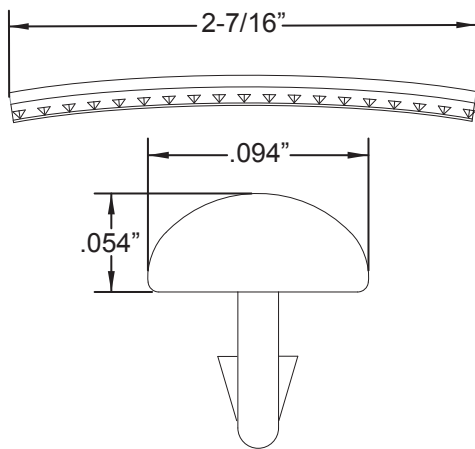

PLEASE NOTE: AS EACH NECK IS SANDED & FINISHED BY HAND, THICKNESS DIMENSIONS MAY VARY SLIGHTLY FROM THOSE SHOWN.

NECK PROFILE: DEEP "C"

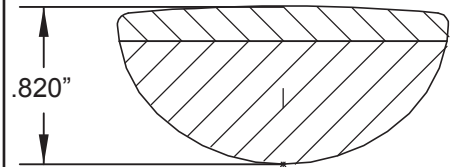

1ST FRET PROFILE

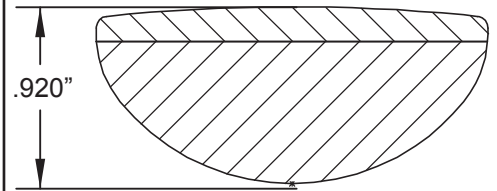

12TH FRET PROFILE

STAGGERED TUNING MACHINES EA: P/N 0990820100
OUTER SHAFT DIAMETER .394"

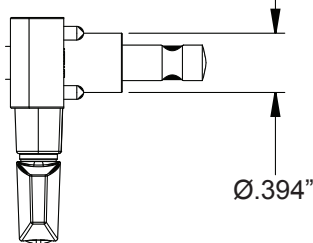

TUNING MACHINE THRU-HOLE
INNER DIAMETER .404"

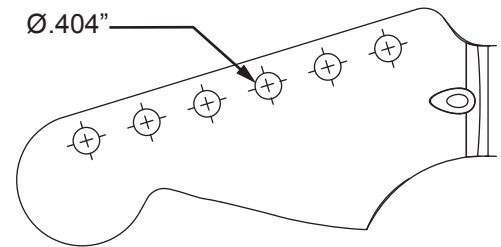

BRIDGE HEIGHT ADJUSTMENT WRENCH:
.050" HEX KEY P/N 0018531049

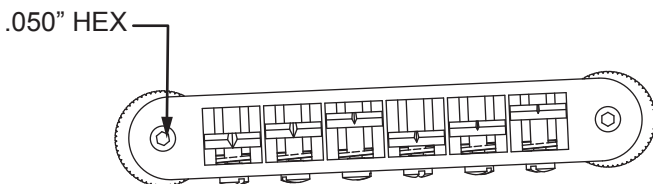

TRUSS ROD NUT: P/N 0994943000
TRUSS ROD ADJUSTMENT WRENCH:
1/8" HEX KEY P/N 0023811049

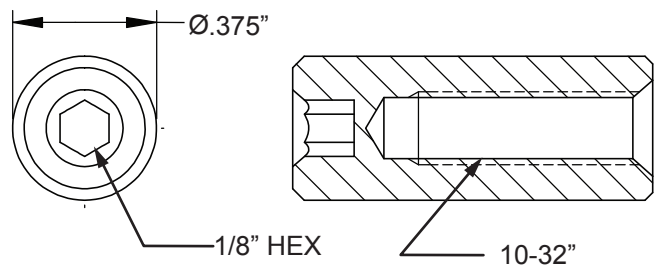

LOGO: 70'S TELE DELUXE W/CORONA .CA
APPLIED UNDER THE FINISH



PICKUP SPECIFICATIONS

| POSITION | MAGNETS | DC RESISTANCE | POLARITY |
|----------|--------------|---------------|----------------|
| NECK | ALNICO 2 BAR | 7.1 - 7.7KΩ | SOUTH NORTH |
| BRIDGE | ALNICO 2 BAR | 7.2 - 7.8KΩ | SOUTH NORTH |