

# PU II TROUBLEMAKER TELECASTER® DLX BIGSBY (0176721706)

## PARTS LAYOUT

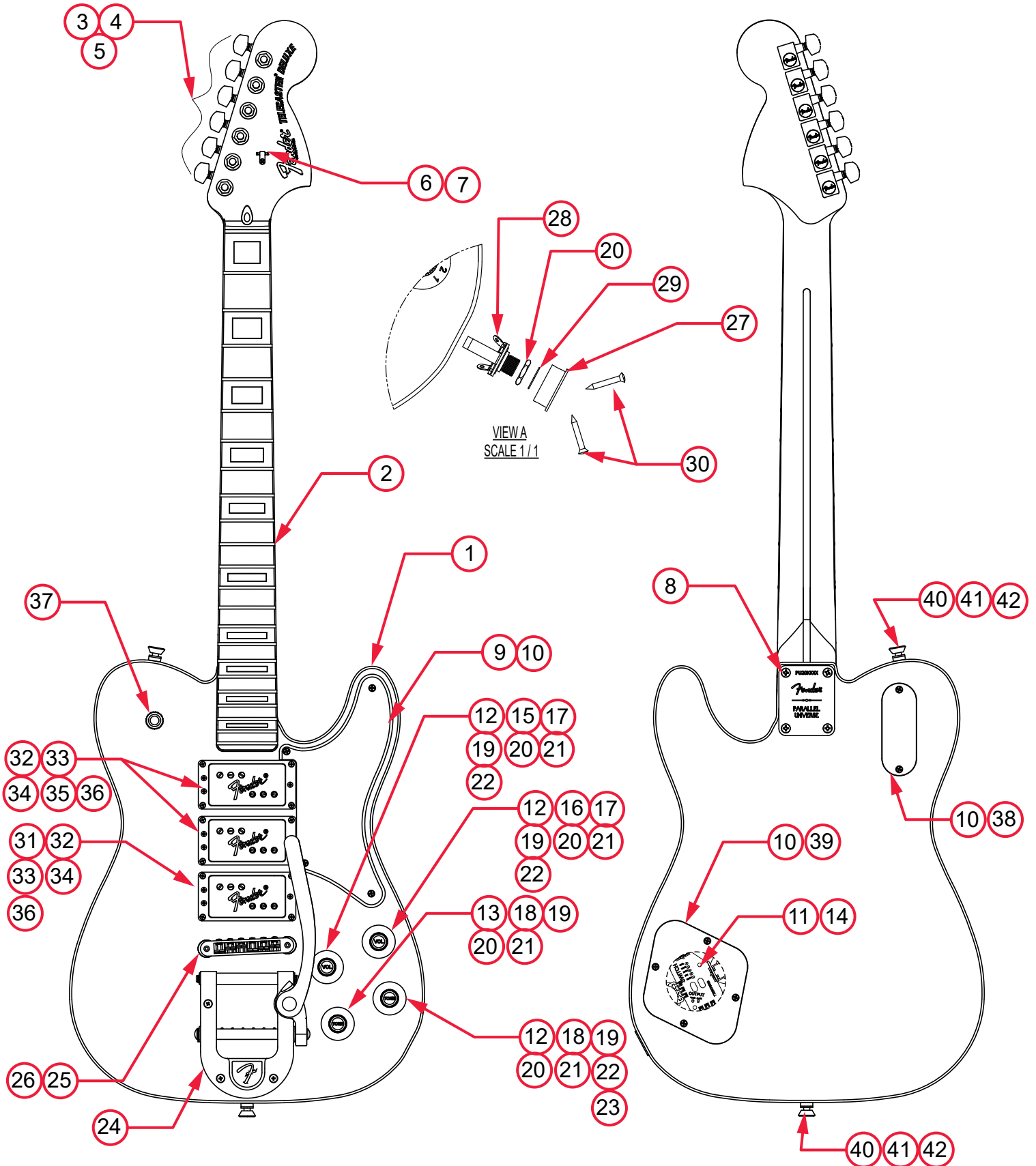

# PU II TROUBLEMAKER TELECASTER® DLX BIGSBY (0176721706)

## PARTS LIST

REF#	DESCRIPTION	PART NUMBER
1	BODY TROUBLEMAKER DLX BIGSBY BLK	7717151506
2	NECK ASSY TELE TROUBLEMAKER DLX BIGSBY MAHOGANY/EBONY FB	7717393000
3	KEY GTR DUAL PIN MTG GOLD/PEARL SET W/HDWR	0990846200
4	WASHER KEY GOLD	7707381000
5	BUSHING KEY GOLD	7707382000
6	STRING GUIDE AS GOLD (2) W/HDWR	0039475049
7	SCREW SMAB 3 X 3/8 RHP GOLD	0018823049
8	SCREW WOOD #8 X 2 OHP STL GOLD	7717316000
9	PICKGUARD TELE TROUBLEMAKER TRIPLE P/U B/W/B	7717152000
10	SCREW SMA 4 X 1/2 OHP GOLD	0994924000
11	CONTROL ASSY PCB TROUBLEMAKER	7720971000
12	POTENTIOMETER WITH PUSH-PUSH SWITCH 500K	7717082000
13	CONTROL 500K AUDIO 20% SOLID	0990835000
14	CAP MPF RDL .022µF 250V 10%	0024832049
15	ADAPTER PCB PDB185 DT HB NK	7720967000
16	ADAPTER PCB PDB185 DT HB BRG	7720969000
17	KNOB VOL BLK 72 TELE CUSTOM GOLD WHT TXT	7717607000
18	KNOB TONE BLK 72 TELE CUSTM GOLD WHT TXT	7717608000
19	WASHER LOCK INTL 3/8 X .687	0016436049
20	NUT HEX 3/8-32x3/32 NI	0016352049
21	WASHER FLAT 3/8x.614 NI	0031153049
22	SPACER NYLON .250OD X .09ID X .125L	7720927000
23	ADAPTER PCB PDB185 DT HB MIDDLE	7720968000
24	VIBRATO B5 "F" BIGSBY GOLD	7717153000
25	POST W/BUSHING T.O.M. API GOLD	7717145000
26	BRIDGE T.O.M. BASE API GOLD	7717150000
27	JACK PLATE GOLD C/S	7711757000
28	JACK PHONE OPEN CIRCUIT 11	0021956049
29	WSHR LCK INTL 3/8x.500x.020 NI	0022384049
30	SCREW WOOD #4 X 3/4 OHP GOLD	7717638000
31	PICKUP DOUBLE TAP PAF BRIDGE GOLD	7717142000
32	RING HBPU FLAT BLACK	0068310000
33	SPRING HB MTG 3/4"	0050167049

\*= NOT PICTURED IN DIAGRAM





# PU II TROUBLEMAKER TELECASTER® DLX BIGSBY (0176721706)

## WIRING ASSEMBLY

COPPER TAPE BETWEEN SWITCH & BODY CAVITY

BARE & BLACK WIRE

3-WAY TOGGLE SWITCH

NECK PICKUP

MIDDLE PICKUP

BRIDGE PICKUP

PICKUP PCB ADAPTER

TONE/PUSH-PUSH CONTROL 2

VOLUME/PUSH-PUSH CONTROL 2

VOLUME/PUSH-PUSH CONTROL 1

FROM PICKUP

BLACK WIRE TO BRIDGE POST

FROM SWITCH

CAPACITOR .022µF

GROUND LUG TO SIDE OF CAVITY

TONE CONTROL 1

VOLUME CONTROL  
DETAIL

COPPER TAPE BETWEEN POT & BODY CAVITY

CONTROL PCB DETAIL

OUTPUT



# PU II TROUBLEMAKER TELECASTER® DLX BIGSBY (0176721706)

## SWITCH AND CONTROL FUNCTION

POSITION	●-○-○ 3 2 1	○-●-○ 3 2 1	○-○-● 3 2 1	PUSH-PUSH SWITCH
CONTROLS	V1+T1	V1+T1+V2+T2	V2+T2	
NECK P/U				VOL 1 DOWN
MIDDLE P/U				TONE 2 DOWN
BRIDGE P/U				VOL 2 DOWN

POSITION	●-○-○ 3 2 1	○-●-○ 3 2 1	○-○-● 3 2 1	PUSH-PUSH SWITCH
CONTROLS	V1+T1	V1+T1+V2+T2	V2+T2	
NECK P/U				VOL 1 UP
MIDDLE P/U				TONE 2 DOWN
BRIDGE P/U				VOL 2 DOWN

POSITION	●-○-○ 3 2 1	○-●-○ 3 2 1	○-○-● 3 2 1	PUSH-PUSH SWITCH
CONTROLS	V1+T1	V1+T1+V2+T2	V2+T2	
NECK P/U				VOL 1 UP
MIDDLE P/U				TONE 2 UP
BRIDGE P/U				VOL 2 DOWN

POSITION	●-○-○ 3 2 1	○-●-○ 3 2 1	○-○-● 3 2 1	PUSH-PUSH SWITCH
CONTROLS	V1+T1	V1+T1+V2+T2	V2+T2	
NECK P/U				VOL 1 UP
MIDDLE P/U				TONE 2 UP
BRIDGE P/U				VOL 2 UP

POSITION	○-●-○ 3 2 1	○-○-● 3 2 1	○-○-○● 3 2 1	PUSH-PUSH SWITCH
CONTROLS	V1+T1	V1+T1+V2+T2	V2+T2	
NECK P/U				VOL 1 DOWN
MIDDLE P/U				TONE 2 UP
BRIDGE P/U				VOL 2 DOWN

POSITION	○-●-○ 3 2 1	○-○-● 3 2 1	○-○-○● 3 2 1	PUSH-PUSH SWITCH
CONTROLS	V1+T1	V1+T1+V2+T2	V2+T2	
NECK P/U				VOL 1 DOWN
MIDDLE P/U				TONE 2 DOWN
BRIDGE P/U				VOL 2 UP

POSITION	○-●-○ 3 2 1	○-○-● 3 2 1	○-○-○● 3 2 1	PUSH-PUSH SWITCH
CONTROLS	V1+T1	V1+T1+V2+T2	V2+T2	
NECK P/U				VOL 1 DOWN
MIDDLE P/U				TONE 2 UP
BRIDGE P/U				VOL 2 UP

POSITION	○-●-○ 3 2 1	○-○-● 3 2 1	○-○-○● 3 2 1	PUSH-PUSH SWITCH
CONTROLS	V1+T1	V1+T1+V2+T2	V2+T2	
NECK P/U				VOL 1 UP
MIDDLE P/U				TONE 2 DOWN
BRIDGE P/U				VOL 2 UP

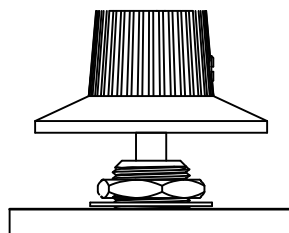

PUSH-PUSH SWITCH UP

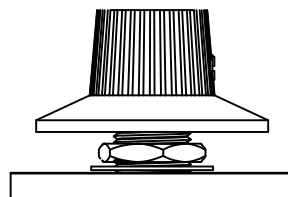

PUSH-PUSH SWITCH DOWN

COMBINED PICKUPS ARE IN PARALLEL

PICKUP IS ON

PICKUP IS OFF



3 POSITION SWITCH

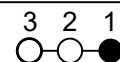

INDICATES POSITION OF 3 WAY SWITCH

# PU II TROUBLEMAKER TELECASTER® DLX BIGSBY (0176721706)

## SWITCH AND CONTROL FUNCTION

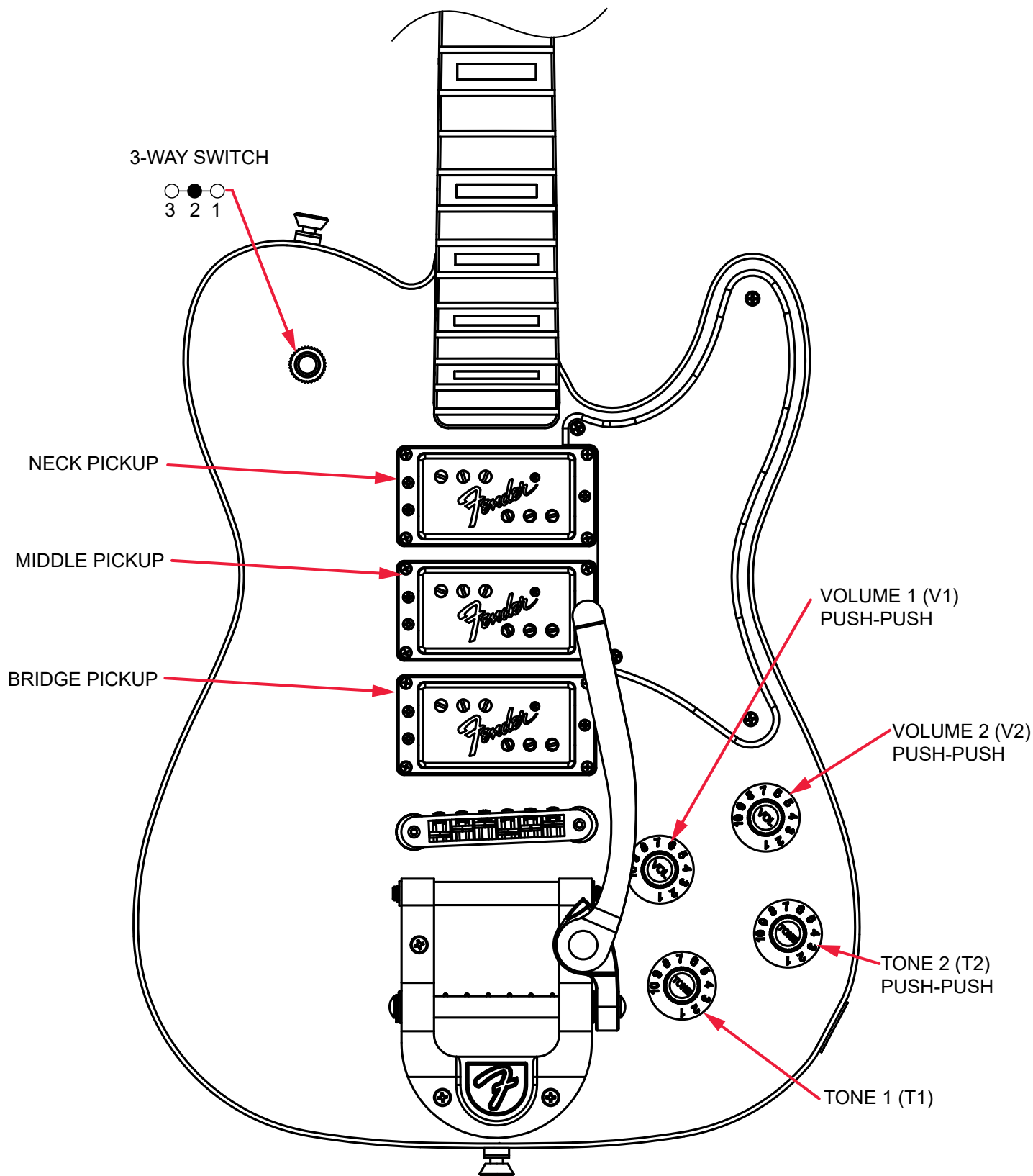

# PU II TROUBLEMAKER TELECASTER® DLX BIGSBY (0176721706)

## ADDITIONAL SPECIFICATION DETAIL

**FRET SIZE: MEDIUM JUMBO**  
(FRET DIMENSIONS ARE BEFORE INSTALLATION)

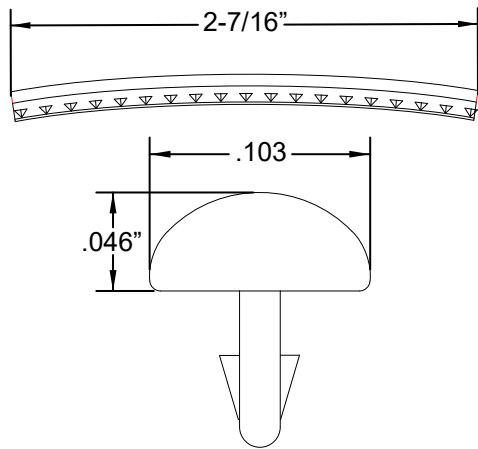

PLEASE NOTE: AS EACH NECK IS SANDED & FINISHED BY HAND, THICKNESS DIMENSIONS MAY VARY SLIGHTLY FROM THOSE SHOWN.

**NECK PROFILE: MODERN "C"**

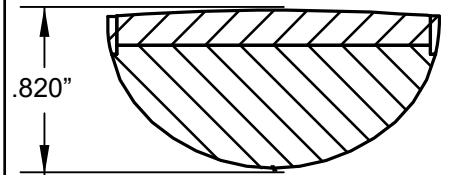

1ST FRET PROFILE

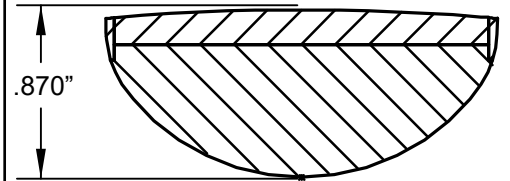

12TH FRET PROFILE

**TUNING MACHINES SET W/HDWR: P/N 0990846200**  
**OUTER SHAFT DIAMETER .394"**

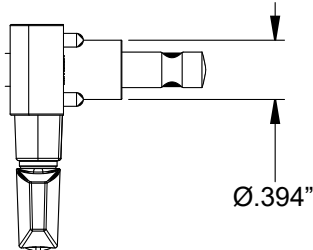

**TUNING MACHINE THRU-HOLE**  
**INNER DIAMETER .404"**

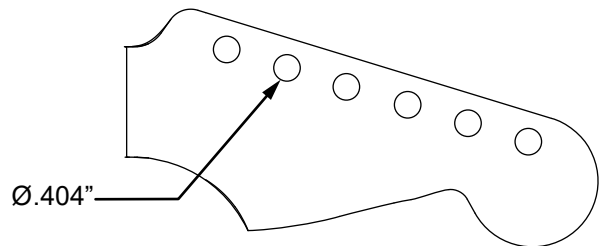

**BRIDGE HEIGHT ADJUSTMENT WRENCH:**  
**2.5MM HEX KEY P/N 0054151000**

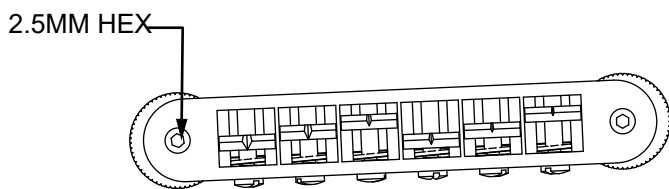

**TRUSS ROD NUT: P/N 0994943000**  
**TRUSS ROD ADJUSTMENT WRENCH:**  
**1/8" HEX KEY P/N 0023811049**

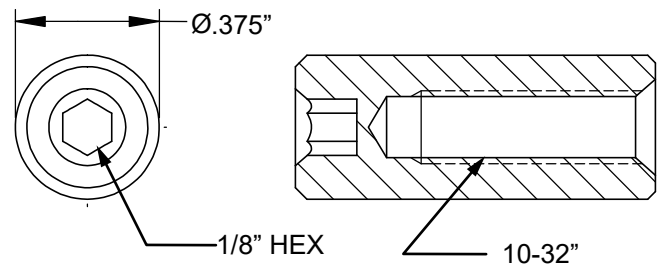

**LOGO: 70'S TELE DELUXE W/CORONA .CA GOLD**  
**APPLIED UNDER THE FINISH**

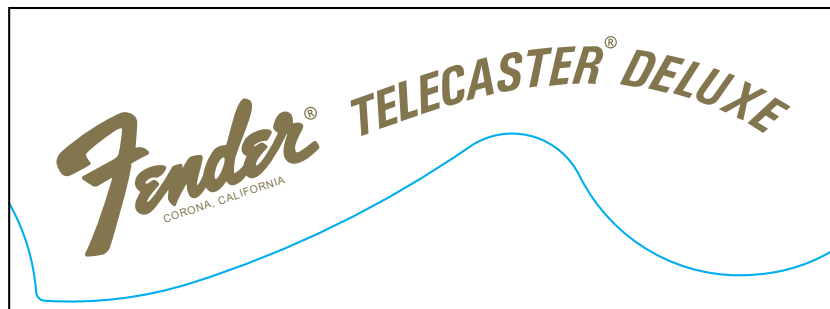

### PICKUP SPECIFICATIONS

POSITION	MAGNETS	DC RESISTANCE	POLARITY
NECK/ MIDDLE	ALNICO 5 BAR	SINGLE COIL 4.8 - 5.4KΩ	SOUTH
		HUMBUCKER 7.6 - 8.2KΩ	NORTH
BRIDGE	ALNICO 5 BAR	SINGLE COIL 10.1 - 10.7KΩ	SOUTH
		HUMBUCKER 15.7 - 16.3KΩ	NORTH

