

American Pro. Classic Hotshot Telecaster

011-4970/4972

Greasebucket PCB

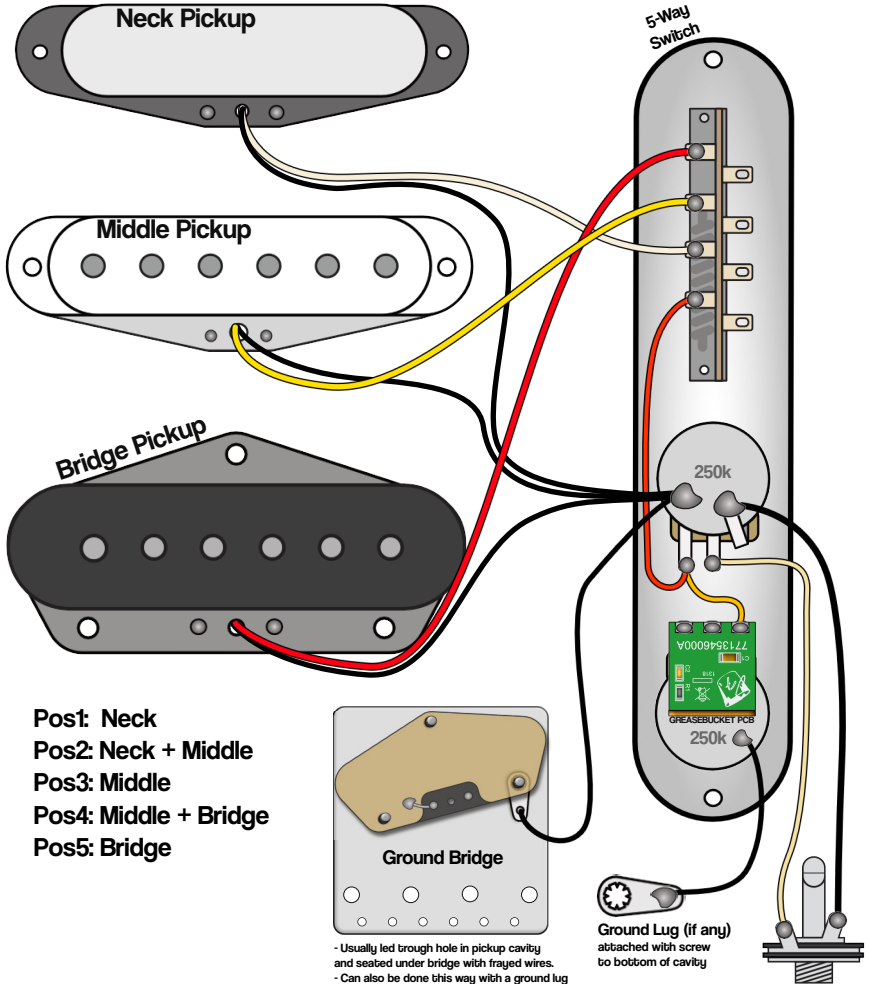

- Pos1: Neck
- Pos2: Neck + Middle
- Pos3: Middle
- Pos4: Middle + Bridge
- Pos5: Bridge

- Usually led through hole in pickup cavity and seated under bridge with frayed wires.
- Can also be done this way with a ground lug sandwiched between bridge and pickup.
- Also recommended to wire ground straight to jack (This removes clutter if you are to work on the wiring in the future)
But you can wire to pot like normal if you wish.

3.13.2026
Rev.A

www.axefiles.com

Graphics by Gerry Haze. all rights reserved