

American Special Tele Wiring

011-5800/5802 | 017-0243

(Greasebucket Mod)

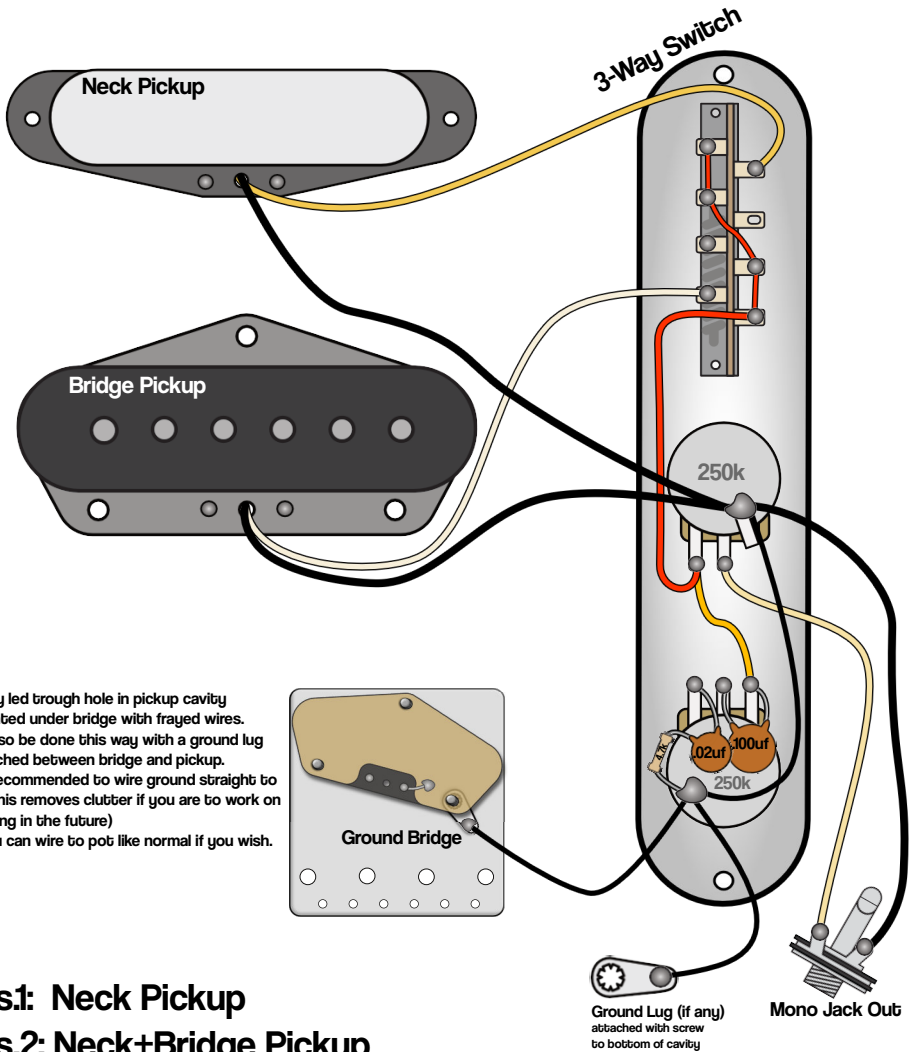

- Usually led through hole in pickup cavity and seated under bridge with frayed wires.
 - Can also be done this way with a ground lug sandwiched between bridge and pickup.
 - Also recommended to wire ground straight to jack (This removes clutter if you are to work on the wiring in the future)
- But you can wire to pot like normal if you wish.

- Pos.1: Neck Pickup
Pos.2: Neck+Bridge Pickup
Pos.3: Bridge Pickup

3.13.2026
Rev.A

www.axefiles.com

Graphics by Gerry Haze. all rights reserved